



# Sareva electric wine set opener

Thank you for purchasing the Sareva Wine Opener Set!

## Before using it for the first time:

To ensure safety and help maintain the high quality of the product, we recommend that you read and follow the instructions carefully.

- Do not immerse the appliance in water or any other liquid to avoid damage to the product.
- Keep a safe distance from the opening of the corkscrew to avoid damage or injury.
- Keep this product away from children.
- Do not try to dismantle the product by yourself, as the warranty will become invalid.
- Keep away from flammable, explosive gas.

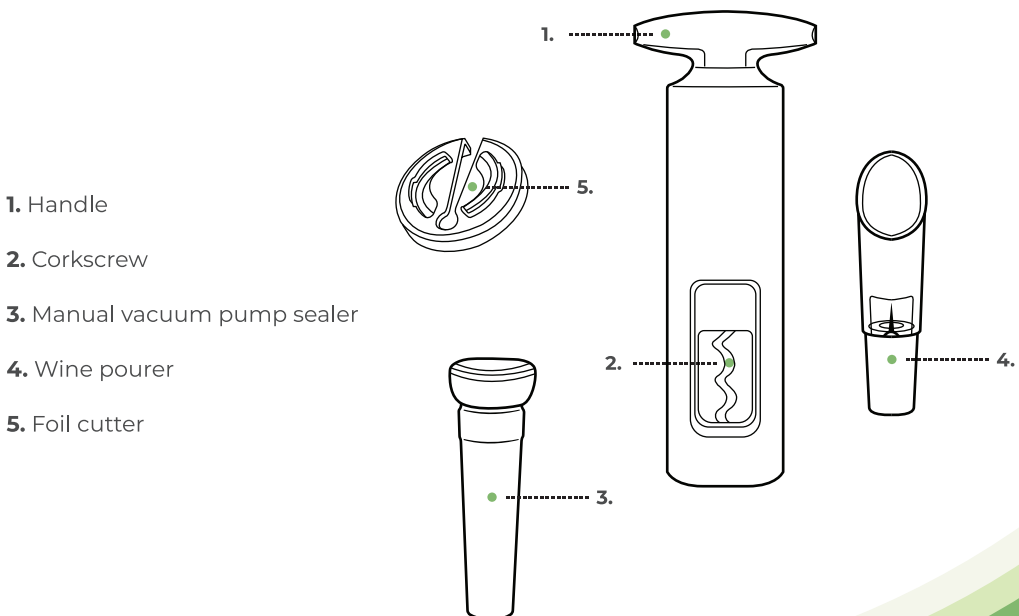

### How to use the wine opener:

1. Remove the foil from the cork with the foil cutter. Place the foil cutter on top of the cork and rotate the bottle until the foil breaks off.

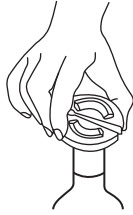

2. To remove the cork, hold the bottle firmly with one hand and the wine opener with the other. Place the bottom of the opener on top of the cork, making sure that it is fully aligned with the wine bottle.

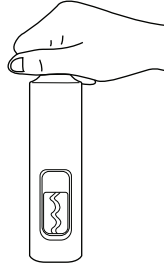

3. Continuing to hold the bottle with one hand, begin twisting the handle clockwise to sink the corkscrew into the cork.

4. Once fully in, twist the handle anti-clockwise until the cork has fully been removed from the bottle.

### How to use the wine pourer:

1. Once the cork has been removed, place the wine pourer securely into the bottleneck.

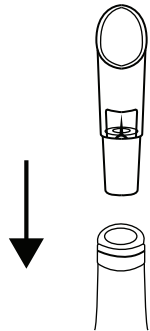

2. Tilt the bottle and the wine will pour out from the spout in a controlled manner, reducing splashes.

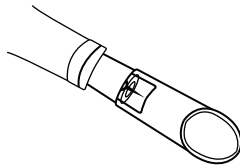

### How to use the manual vacuum pump sealer:

1. Insert the sealer into the open bottleneck firmly.

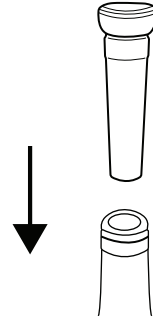

2. Seal the bottle by pumping the handle up and down about 15 times, as depicted in the figure below. This method is ideal for a bottle with about half of its contents left.

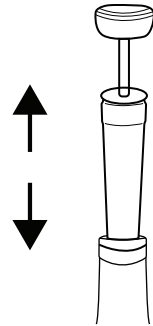

3. Store the sealed wine bottle in a wine cabinet or refrigerator for even better results. For the best results, the contents of the bottle should not be left for longer than 7 days.